

GALLOPING INTO PROSPERITY

CNY EDITION 2026



INSIGNIA INTERIOR



TABLE OF CONTENT

EDITORS NOTE

FORTUNE

Chinese Horoscope 2026

PROJECT COVERAGE

The Design and Build of KSL Riviera Sales
Gallery & Show Unit

INS CONCEPT

Apartment Common Area- Earthen Still

TEAM

Insignia Christmas Dinner at Sheraton
Welcome Aboard, Nisa!

FESTIVE DECOR & TIPS

Lunar Classics collection By Urban Li'l,
Lunar New Year Deco Essentials

GUIDE

Lunar Buffet Feasts to Welcome Prosperity

HAPPENINGS

CNY Mall Decor

ARCHITECTURE

Exploring Chinese Architecture: A Harmonious
Blend of Tradition and Innovation

EDITORS NOTE.

Galloping Forward!

“Run boldly, stand strong, and let success keep pace with you—welcome the Year of the Horse.”

The arrival of Chinese New Year marks more than a change of calendar — it is a time for reflection, intention, and renewed momentum. As we welcome 2026, the Year of the Horse, we are reminded of the strength, vitality, and drive for progress this zodiac represents — qualities that continue to shape our vision and work.

In this CNY edition, prosperity is explored beyond mere fortune, embracing growth, balance, and well-being. Our Fortune segment offers a lighthearted look at what the year may hold as you gallop into the months ahead.

We are also delighted to share our recent completed project— KSL Riveria Sales Gallery & Show Unit, along with a design proposal for a central-region apartment common area — showcasing the incredible work of the Insignia team and how our thoughtful designs enhance everyday spaces.

On the team front, we recap our year-end Christmas dinner at Sheraton Johor Bahru — a meaningful moment to appreciate the team’s dedication throughout 2025. We’re also delighted to welcome Nisa from marketing as the newest member of the Insignia family.

To celebrate the festive season, we feature CNY décor inspirations — from contemporary finds at Urban Lil’, to ideas for memorable reunion gatherings — helping create spaces filled with warmth and joy.

As we stride into the Year of the Horse, we do so with optimism and energy. Wishing you abundance, progress, and inspired momentum!

Gong Xi Fa Cai and Happy Chinese New Year — may you gallop confidently toward success and new opportunities!

INSIGNIA INTERIOR

2026 FORTUNE CHINESE HOROSCOPE



HORSE (Mǎ)

(1930, 1942, 1954, 1966, 1978, 1990,
2002, 2014, 2026)

Those born in the Year of the Horse face a year of **fluctuating fortune** as they enter their own zodiac year and experience a clash with Tai Sui. Situations may change quickly, so **caution, patience, and steady progress are essential.**

Positive career momentum is supported by auspicious stars, **bringing recognition and opportunities**, especially for those in government or disciplined professions. However, inauspicious influences may impact **health and relationships**, making it important to care for personal well-being, watch over elders, **avoid accidents, and keep a low profile throughout the year.**

Career: ★★★★★
Wealth: ★★★

Relationship: ★★
Health: ★★



Sheep (Yáng)

(1931, 1943, 1955, 1967, 1979, 1991, 2003, 2015, 2027)

Those born in the Year of the Goat enjoy a **generally smooth and favorable year** in the Horse Year due to a harmonious relationship with Tai Sui, **bringing opportunities for new collaborations and growth.** However, fortunes **may show polarized outcomes, with some facing unexpected obstacles, so adaptability is important.**

Auspicious stars support wealth, helpful connections, and creative inspiration, but attention should be given to interpersonal and family matters. **Careful communication is advised to avoid being caught in difficult situations.**

Career: ★★★★★
Wealth: ★★★★★
Relationship: ★★★
Health: ★★★



Monkey (Hóu)

(1932, 1944, 1956, 1968, 1980, 1992, 2004, 2016, 2028)

Those born in the Year of the Monkey see their **fortune stabilize** in the Horse Year after a challenging period. It is a **good time to reset, rebuild momentum, and pursue career or academic growth, especially through travel or overseas opportunities.** However, **attention should be paid to the emotional well-being and health of the elderly, with extra care advised for family matters.**

Career: ★★★★★
Wealth: ★★★
Relationship: ★★★
Health: ★★★

2026 FORTUNE CHINESE HOROSCOPE



Rooster (Jī)

(1933, 1945, 1957, 1969, 1981, 1993,
2005, 2017, 2029)

Those born in the Year of the Rooster can expect a **calm and gradually uplifting year** in the Horse Year. Helpful connections and social energy are on the rise, bringing positive opportunities in work, finances, and relationships.

Personal charm is enhanced, making it a favorable year for romance—especially for singles—while those in relationships should **stay mindful of boundaries**. A gentle reminder to handle money and personal matters clearly and thoughtfully will help keep the year smooth and stress-free.

Career: ★★★★★

Relationship: ★★★

Wealth: ★★★

Health: ★★★★★



Dog (Gǒu)

(1930, 1942, 1954, 1966, 1978, 1990,
2002, 2014, 2026)

Those born in the Year of the Horse face a year of **fluctuating fortune** as they enter their own zodiac year and experience a clash with Tai Sui. Situations may change quickly, so **caution, patience, and steady progress are essential**.

Positive career momentum is supported by auspicious stars, **bringing recognition and opportunities**, especially for those in government or disciplined professions. However, inauspicious influences may impact **health and relationships**, making it important to care for personal well-being, watch over elders, **avoid accidents, and keep a low profile throughout the year**.

Career: ★★★★★

Relationship: ★★

Wealth: ★★★

Health: ★★



Pig (Zhū)

(1935, 1947, 1959, 1971, 1983, 1995,
2007, 2019, 2031)

Those born in the Year of the Pig can expect a **steady and stable Year of the Horse**, with opportunities to regroup and move forward confidently. Auspicious stars **bring helpful support, favorable career prospects, steady business growth, and expanding social connections**.

However, inauspicious stars suggest **paying attention to health, minor injuries, and careful financial management** to avoid unnecessary expenses or small losses.

Career: ★★★★★

Relationship: ★★

Wealth: ★★★

Health: ★★★★★

2026 FORTUNE CHINESE HOROSCOPE



Rat (Shǔ)

(1933, 1945, 1957, 1969, 1981, 1993,
2005, 2017, 2029)

Those born in the Year of the Rat face **a year of ups and downs** in the Horse Year due to a clash with Tai Sui. Sudden changes in work or life are possible, so it's best to **act cautiously**.

Celebrating major milestones—like marriage, a new baby, buying property, or starting a business—can help offset challenges and bring positive energy.

Career: ★★★★★

Wealth: ★★★

Relationship: ★★★

Health: ★★



Ox (Niú)

(1925, 1937, 1949, 1961, 1973, 1985,
1997, 2009, 2021)

Those born in the Year of the Ox face a **challenging year** in the Horse Year, with **weaker social support and potential setbacks in health or daily life**. Staying calm and steady is key.

Auspicious stars **bring opportunities** through connections, while investment gains may come with guidance from mentors or reliable partners. **Watch out for financial ups and downs—plan** carefully, save, and consider turning part of your income into tangible assets.

Career: ★★★★★

Wealth: ★★★

Relationship: ★★

Health: ★★



Tiger (Lǎohǔ)

(1926, 1938, 1950, 1962, 1974, 1986,
1998, 2010, 2022)

Those born in the Year of the Tiger face a steady but challenging year in the Horse Year, with little help from auspicious stars. Progress depends on personal effort, making it a year for hard work and perseverance.

Career development is possible—consider further training, promotion opportunities, or overseas plans—but be cautious of difficult people or office gossip. Staying low-key and patient will help navigate challenges smoothly.

Career: ★★★★★

Wealth: ★★★★★

Relationship: ★★

Health: ★★

2026 FORTUNE CHINESE HOROSCOPE



Rabbit (Tùzǐ)

(1927, 1939, 1951, 1963, 1975, 1987,
1999, 2011, 2023)

Those born in the Year of the Rabbit face a year of potential misunderstandings in the Horse Year, which may affect relationships with partners, friends, or collaborators. **Open communication is key to resolving conflicts.**

Auspicious stars bring support from benefactors, and small gains from intuition or investments are possible, though large risks should be avoided. Caution is advised in collaborations—clarify responsibilities and finances to prevent disputes.

Career: ★★★ Relationship: ★★★
Wealth: ★★★★★ Health: ★★



Dragon (Lóng)

(1928, 1940, 1952, 1964, 1976, 1988, 2000,
2012, 2024)

Those born in the Year of the Dragon can expect a **generally stable year** in the Horse Year, though challenges may arise and careful planning is needed.

Auspicious stars help **smooth out most obstacles**, so adopting a calm, go-with-the-flow mindset is recommended. **Be cautious** of minor accidents or shocks when traveling, and avoid joint ventures with women to prevent disputes over money.

Career: ★★★★★ Relationship: ★★
Wealth: ★★★★★ Health: ★★



Snake (Shé)

(1929, 1941, 1953, 1965, 1977, 1989, 2001, 2013, 2025)

Those born in the Year of the Snake enter a more **stable phase** in the Horse Year, especially if positive events from the past year carried over. It's a good time for a fresh start with a positive mindset.

Auspicious star **supports career growth, with opportunities** for promotion or salary increases.

Be mindful of stress in new or unfamiliar environments—especially for those who recently changed jobs—and make sure to balance work and rest to protect well-being.

Career: ★★★★★ Relationship: ★★★
Wealth: ★★ Health: ★★



PROJECT COVERAGE

KSL Riviera Sales Gallery & Show Unit

From blueprint to grand opening, the KSL Sales Gallery was a fully integrated design-and-build journey shaped by vision, precision and purpose. Conceived as more than just a showcase space, this project brought together architectural planning, construction coordination and interior detailing into one seamless narrative. Every material choice, lighting layer and spatial arrangement was carefully curated to reflect KSL's brand identity while crafting an inviting, immersive experience for prospective buyers.

The result is a contemporary gallery that balances warmth with sophistication—where clean architectural lines, natural textures, and thoughtfully framed visual displays guide visitors through the development story. In this feature, we unveil the process behind the KSL Sales Gallery interior design project—where strategy meets creativity, and every design decision supports a powerful first impression.



Furniture Layout

The furniture layout is thoughtfully planned to support both functionality and flow, featuring a welcoming statement area, a reception counter, a main model base and typical model base, and multiple discussion areas in varied seating settings. An LED screen is strategically positioned in the main common area to showcase the development project, providing visitors with engaging visual content and an overview of the master plan.





Show Unit

Features a common area, dining space and master bedroom—carefully designed to evoke a sense of tranquillity and comfort. The interior embraces key elements of the modern contemporary concept, incorporating natural materials such as light wood, soft textiles, a neutral colour palette, and clean-lined furniture to create a cozy and calming atmosphere. Every detail is thoughtfully curated to reflect comfort, simplicity and timeless appeal—perfect for modern living.



Master Bedroom

It adopts a modern soft luxe concept, focusing on clean lines, gentle curves, and subtle layering of textures. A neutral palette of warm beige, cream, and soft brown creates a serene and sophisticated ambience.

Vertical wall panel detailing behind the bed enhances the perception of height while integrated warm LED lighting introduces a hotel-inspired mood. The combination of smooth cabinetry, upholstered bedframe, and plush textiles adds dimension without visual heaviness.

The built-in vanity and open shelving unit provide functional storage while maintaining a streamlined silhouette. Curved elements, such as the suspended wardrobe casing and accent stool, soften the overall composition, balancing structure with comfort.





Bedroom 2



Kids Bedroom

INS CONCEPT

Apartment Common Area: Earthen Still, A Sanctuary of Timber & Tranquility



Sets within a residential project in the central region, this proposed common area design draws inspiration from Earthen Still design concept — an approach rooted in natural materials, quiet textures, and a sense of grounded calm. The design envisions a tranquil shared space where residents can unwind, connect, and experience balance within everyday urban living.

It celebrates the raw, honest beauty of timber, clay, stone, and organic fibers, shaping spaces that feel grounded, warm, and deeply restorative. At its core, the concept is about stillness—not emptiness, but a mindful calm created through material authenticity, muted earth tones, and balanced composition.

Wood plays a central role, with natural grains and imperfections embraced to create warmth and authenticity. Clay finishes, lime-washed walls, and tactile textiles add softness and depth, while an earthy palette of browns, beiges, terracotta, and soft greys brings harmony without visual clutter.

Lighting is treated as a key design element, with gentle illumination enhancing textures and creating subtle, shifting shadows. Simple, intentional furniture allows materials to take focus while ensuring comfort and ease.

Earthen Still transforms interiors into sanctuaries—spaces that invite pause, reflection, and reconnection. It is not about excess or ornamentation, but about balance, mindfulness, and living in quiet harmony with the natural world.



Furniture Layout

FURNITURE LAYOUT

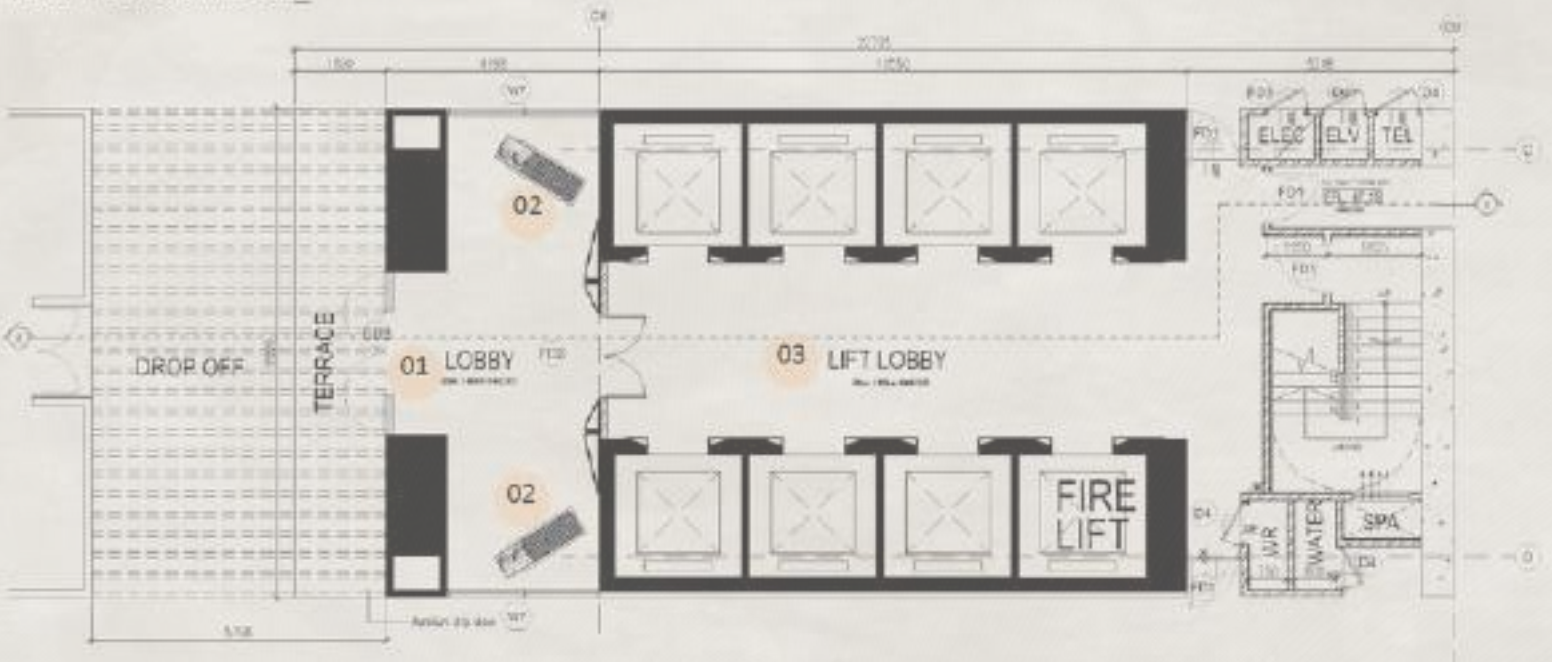

1. Entrance Zone (01 - Lobby Entry)

The main entrance connects directly from the drop-off area through the terrace into the lobby. This zone acts as a transition space between exterior and interior environments. The layout ensures:

- Clear visibility toward the lift lobby upon entry
- Unobstructed pedestrian flow from drop-off to lifts
- Adequate maneuvering space for residents, visitors, and luggage

2. Waiting Areas (02)

Two waiting areas are positioned on either side of the entrance corridor. This symmetrical placement balances the space visually while keeping seating away from primary circulation paths.

Key considerations:

- Seating is arranged against the walls to maintain a clear central walkway.
- The layout prevents congestion near the entrance doors.
- Users can wait comfortably without obstructing access to the lift lobby.
- Furniture placement maintains compliance with fire safety and accessibility requirements.

3. Lift Lobby (03)

The lift lobby is centrally positioned and directly accessible from the main entrance. It provides access to:

- Multiple passenger lifts
- A designated fire lift
- Staircase access
- Utility/service rooms (electrical, water, telecommunications)

4. Circulation & Accessibility

The layout maintains a clear central axis from the drop-off through the entrance to the lift lobby. This direct line of movement enhances:

- Wayfinding clarity
- Accessibility for wheelchair users
- Efficient movement during high-traffic periods
- Compliance with safety and evacuation standards

All furniture placement avoids interference with lift access, staircases, and fire escape paths.

5. Overall Design Intent

The overall furniture strategy supports:

- Functional efficiency
- Comfortable waiting experience
- Clear zoning between movement and seating
- Safety and regulatory compliance
- A welcoming and organized first impression for residents and visitors

The design balances aesthetics with practicality, ensuring the lobby operates efficiently as the primary common area of the apartment building.





Lift Lobby



Function Hall



Function Hall



**Management Office
Reception**



Games Room



Gymnasium



TEAM Insignia Christmas Dinner

The holiday season is always a special time to pause, reflect, and celebrate. Last month, our team did just that at our annual Christmas dinner at the luxurious Sheraton Hotel in Johor Bahru. The evening was a beautiful blend of laughter, delicious cuisine, and heartfelt moments as we came together to appreciate not only the festive season but also the achievements and milestones throughout 2025

The night became even more memorable with festive games that sparked laughter and friendly competition – from the gift exchange and ‘Lucky Cut the String’ to our ‘Sticky Notes Challenge’. We also held a lucky draw session, with an iPad as the grand prize, adding extra excitement and ending the evening on a high note!

A huge thank you to everyone who joined us and contributed to the evening’s success. Your enthusiasm, laughter, and holiday cheer truly made the night unforgettable!

TEAM

Welcome Abroad, Nisa!

Hi everyone! I'm Nisa. My hobby is watching Netflix, especially thriller and horror movies. I'm drawn to intense plots and unexpected twists that make each story exciting.

I also love creating videos whenever I visit a nice café or a beautiful place. I enjoy capturing the atmosphere, little details and moments that make each location feel special. It's also a creative way for me to keep memories and share my experiences.

Things that make me happy :

Travelling to a new place and eating good food!



Getting To Know Nisa!

Q: What is your role in the company?

I work as an Assistant Marketing Executive, where my role primarily involves managing the company's social media platforms and creating product-related content.

Q: What do you enjoy most about your job so far?

I enjoy the creative process, especially working on social media content. It's exciting to explore different ideas, visuals and storytelling approaches to better connect with our audience.

Q: What skills or interests do you bring to the team?

I have a strong interest in content creation and visual storytelling. I enjoy creating videos and capturing aesthetic moments, which helps me bring fresh ideas into our social media and product content.

Q: What are you most excited about as part of the team? Do you have any messages to share with the team?

I'm excited to learn from the team, improve my skills in marketing and content creation, and contribute ideas that help strengthen the company's brand presence.

I'm grateful for the warm welcome and support from everyone. I look forward to working closely with the team and growing together.

FESTIVE DECOR

Lunar Classics Collection By Urban Li'l.

As we usher in the vibrant energy of Chinese New Year 2026, it's time to refresh our homes with décor that celebrates tradition, auspiciousness, and thoughtful design. Drawing inspiration from timeless festive classics, this season's décor is all about bringing warmth, meaning, and modern elegance into every corner of your living space. From symbolic wall art and personalised family plaques to handcrafted ornaments that evoke prosperity and harmony, the right décor can elevate both the aesthetic and emotional atmosphere of the home—creating spaces that feel welcoming for family gatherings and auspicious for the year ahead.

1



1.

Chinese Zodiac Ornament Charms (RM48)

Chinese zodiac is represented by 12 zodiac animals - Rat, Ox, Tiger, Rabbit, Dragon, Snake, Horse, Goat, Monkey, Rooster, Dog, and Pig. One for each family member, our Chinese Zodiac Ornaments with an auspicious greeting 福 are designed to adorn your festive plants and make perfect gifts for families.

2



2.

Spring Couplet Wall Decal (RM126)

This decorative decal features beautifully crafted Chinese calligraphy displayed on vibrant red backgrounds, symbolizing luck, joy, and celebration. Traditionally placed on both sides of doors or walls during the Lunar New Year, the spring couplet represents blessings for the coming year—such as wealth, harmony, longevity, and success.

FESTIVE DECOR

Lunar Classics Collection By Urban Li'l.

3



3.

QUATREFOIL Bloom Plaque Frame (RM340)

Framed to enhance depth and structure, this piece features premium fabric decal artwork layered within the frame, offering a tactile, matte finish that feels both modern and timeless. Ideal for doors, feature walls or as a thoughtful Lunar New Year gift.

4.

Pineapple Bunting (RM126)

Perfect for draping along walls, doorways, shelves, or feature panels, this bunting adds a playful yet refined touch without overwhelming the space. Its lightweight design makes it easy to style and reposition, whether you're decorating a cosy home setting or a welcoming commercial space.

4

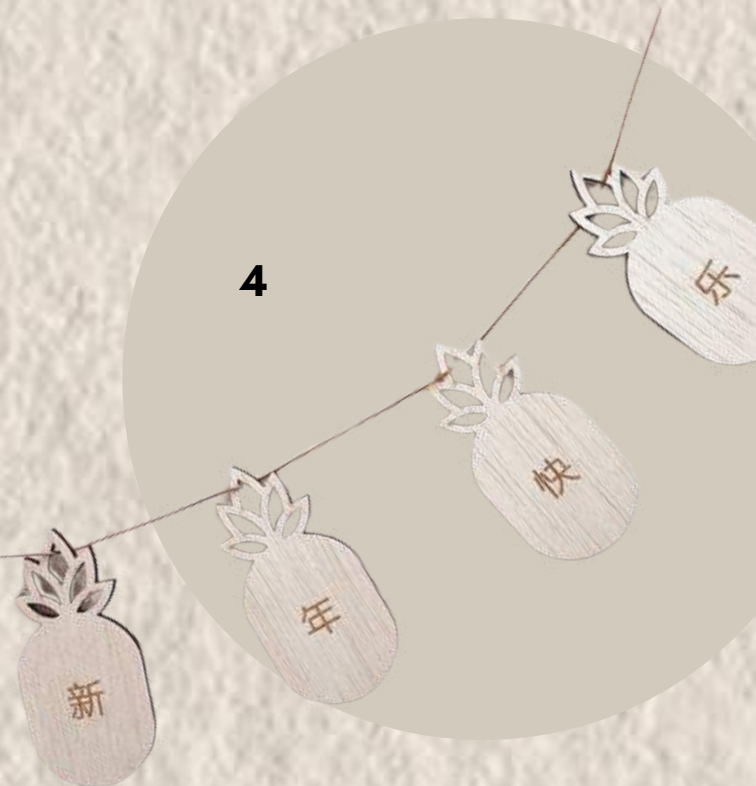

FESTIVE DECOR

Lunar Classics Collection By Urban Li'l.

5



5.

HARMONYU Blessing Sign Plaque (RM215)

The HARMONYU Blessing Sign Plaque is a contemporary interpretation of traditional Chinese blessing signage.

Designed to be displayed on doors, walls or shelves, this plaque works beautifully as a festive accent or a meaningful gift.

6.

Japandi Pineapple Plaque (RM183)

Japandi Pineapple Plaque blends the quiet elegance of Japanese minimalism with the warmth of Scandinavian design, reimagining a classic symbol of prosperity in a modern, understated form. In Chinese culture, the pineapple is associated with wealth and good fortune, making it a meaningful element for Chinese New Year décor

6



TIPS

Lunar New Year Décor Essentials





Red Lanterns for Chinese New Year

Nothing embodies the festive spirit like Chinese lantern new year. Hang Chinese lantern Chinese New Year around doors, windows, or living spaces. Red lanterns not only enhance Chinese New Year home decor but also symbolize protection, happiness, and prosperity for the new year.



Chinese New Year Candles

Light up your home with Chinese Lunar New Year decorations, such as candles in red, gold, or floral designs. These Chinese New Year table decorations and table centerpieces can add warmth and meaning, encouraging gratitude and prosperity in 2026.



Paper Cutting and Calligraphy

Chinese New Year wall decoration is essential for a traditional look. Hang Chinese New Year wall stickers, calligraphy scrolls, and chunlian with horse motifs. These Chinese New Year door decor ideas are perfect for both homes and offices.



Flower Arrangements for Chinese New Year

In 2026, Chinese New Year flower arrangements featuring orchids, peonies, and horse-themed blooms enhance the celebratory atmosphere. Flowers like peach blossoms, Chinese New Year floral decorations, or Chinese New Year bouquet symbolize growth, prosperity, and luck.



Mandarin Oranges Trees

A classic Chinese New Year plant decoration, the mandarin tree or soft toy version represents wealth and abundance. Use it as a table centerpiece or place it near entrances to boost positive energy.



Upside Down Fu Characters

During Chinese New Year, the character Fu (福), which means "good luck" and "happiness," is a common sight in homes and businesses. What makes it unique is that it's often displayed upside down. Why? Because in Chinese culture, the phrase for "upside down" (dao 倒) sounds similar to the word for "arrive" (dao 到). This clever wordplay symbolizes the arrival of good fortune into the household.

GUIDE

Lunar Buffet Feasts to Welcome Prosperity

Looking for the perfect dinner buffet for Chinese New Year in Malaysia? Considering our recommendation, known for its exquisite Chinese cuisine and elegant ambiance, it's an ideal setting to gather and celebrate with family and friends. Hope this helps! Enjoy your reunion dinner!

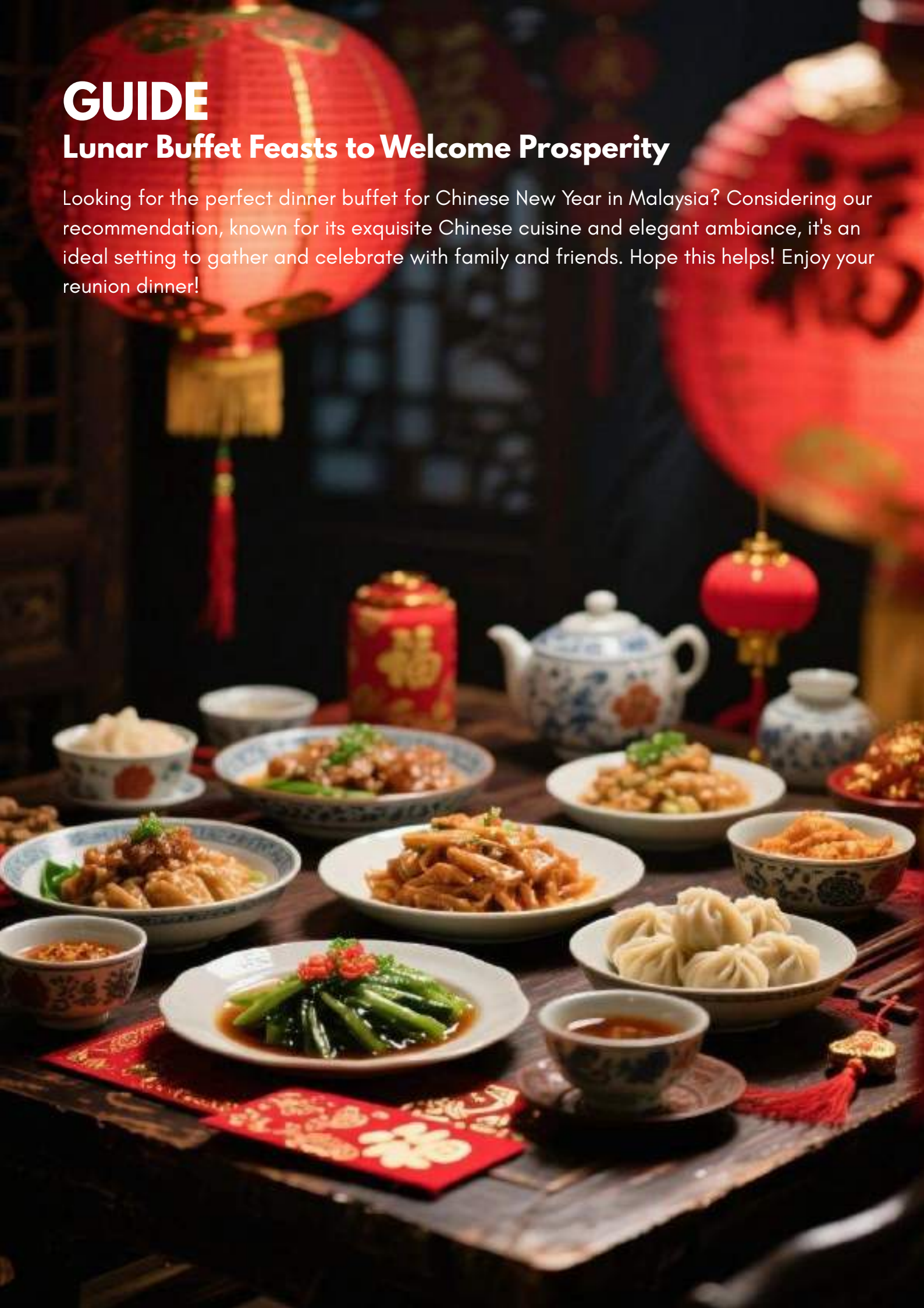



AFE BLD, PERMAS JAYA

**FROM 16, 17 & 18 FEBRUARY 2026
RM208 PER PERSON**

Step into a world of festive indulgence at Café BLD, where every detail of our Chinese New Year Dinner Buffet is crafted to delight the senses. Experience the vibrant flavors of Yee Sang with lobster at every table, interactive BBQ live stations, and a sumptuous array of local and international favorites, each dish prepared to perfection. From the first bite to the last, every morsel promises joy, celebration, and unforgettable memories with family and friends.

Let the lively atmosphere, sizzling stations, and delectable creations set the stage for a truly extraordinary CNY dining experience. At Café BLD, every table is a gathering of happiness, every flavor tells a story, and every moment is a celebration of the new year.

16 February
6:30 PM – 10:00 PM
MYR 198 nett per adult

17 & 18 February
6:30 PM – 10:00 PM
MYR 208 nett per adult



ST. GILES SOUTHKEY

16th - 18th FEBRUARY 2026
RM198 PER PERSON

This Fortune-Blessed Feast Chinese New Year Festive Buffet is more than just a buffet, it's a celebration of the blessings we share. Dig into classic favorites that symbolize wealth and longevity, and enjoy a festive atmosphere filled with the warmth of the season. Let's toast to a 2026 filled with health, happiness, and a harvest of good fortune for the whole family.

Highlights

- Special Activities: Chinese Mask Changing & Traditional Music Performance
- Special Menu: Poon Choi | Steamed Pomfret | Roasted NZ Lamb Leg

Promotion

- Early Bird Promo: 20% Discount for Booking Confirmation & Full Payment before 31 January 2026



TROVE JOHOR BAHRU

16 FEBRUARY 2026 / NEW YEAR EVE BUFFET DINNER
RM88 PER PERSON

Gallop into the Year of the Horse with abundance, joy, and festive flavours! This Chinese New Year Eve, join us for our Prosperity Delights Buffet Dinner on 16 February 2026, from 6.30pm to 9.30pm at Lada & Clove, Level 8. Indulge in a sumptuous spread of auspicious dishes, including Deep-Fried Whole Fish with Nyonya Style Sauce, golden crispy Nestum Oat Prawn, and toss for prosperity with our colourful Yee Sang. Celebrate with family and friends in a night filled with laughter, abundance, and unforgettable festive flavours and let every bite bring luck, happiness, and prosperity for the year ahead!

FROM 19th JANUARY- 3 MARCH 2026 / CNY SAO GONG & REUNION DINNER
RM118++ PER PERSON

Abundance Set (10 pax) - RM1,188nett
Joyful Set (10 pax) - RM1,388nett
Longevity Set (10 pax) - RM1,888nett



Four Seasons Kuala Lumpur

15 JANUARY to 3 MARCH 2026

RM1388 PER PERSON

Nothing beats a lavish Lunar New Year dinner at Yun House. With set menus and a la carte dishes available, your dining experience is sure to be memorable. Meticulously prepared by Executive Chinese Chef Jimmy Wong, you'll find that each set menu is elevated with dishes that will leave you wanting more.

No matter which set you'll end up opting for, your culinary adventure begins with one of Yun House's signature Yee Sang—Australian Lobster Yee Sang, Smoked Salmon Fish with Black Truffle Yee Sang, Crispy Softshell Crab Yee Sang and Vegetarian Abalone Yee Sang—before moving on to the main dishes. On the menu, you'll spot highlights like Braised Premium Abalone, Crispy Roasted London Duck with Herbal Essence, Fragrant Fried Rice, and Braised Innaniwa Noodles.

Majestic: MYR 588 per person (minimum 4 guests)

Auspicious: MYR 888 per person (minimum 4 guests)

Fortuity: MYR 1388 per person (minimum 4 guests)

Vegetarian: MYR 338 per person (available for individual guests)



Four Points by Sheraton Kuala Lumpur, Chinatown

16 JANUARY 2026
RM198 NETT PER PERSON

Trust Quan's Kitchen to deliver the best spread for the Lunar New Year. At Four Points by Sheraton Kuala Lumpur, Chinatown, Quan's Kitchen invites you and your loved ones to a remarkable feast featuring timeless and contemporary delights. On the menu, you'll find dishes like Marinated Jellyfish Salad, Wok-Fried Buttermilk Crab with Deep-Fried Mantau, Teo Chew-Style Steamed Fish, Mongolian Roasted Lamb Leg, Yong Tau Fu station and a Roasted Duck with Egg Crepe Station. What sets this apart from others is its twist on the classic Peking Duck by replacing pancakes with egg crepes—a definite must-try. Book now from 2 - 31 January 2026 to enjoy an Early Bird 35% discount on the Chinese New Year buffet.

EXPLORING THE BEAUTIFUL CHINESE NEW YEAR DECORATIONS IN MALAYSIA'S SHOPPING MALL!

HAPPENINGS



THE EXCHANGE TRX, KUALA LUMPUR
Theme: Gallop Into Grandeur (now until 22nd February 2026)

Experience beautiful new beginnings and festive highlights, including cultural showcases, performances, pop-ups and hands-on workshops that celebrate togetherness.



**THE GARDENS MALL,
KUALA LUMPUR**
**Theme: A Chinoiserie
Connection**
**(28th January 2026-
22nd February 2026)**

Feel the elegance of Chinoiserie this Chinese New Year at The Gardens Mall, where classic oriental motifs and festive décor come together to create a refined and celebratory atmosphere.



IOI CITY MALL, PUTRAJAYA

Theme: Journey To Prosperity (9th January 2026- 22nd February 2026)

The highlight includes a striking large-scale horse installation alongside lantern displays and symbolic festive elements, creating an energetic atmosphere that celebrates prosperity, connection, and new beginnings for the year ahead.



PAVILION KL **Theme: Journey To Prosperity** **(now- 22nd February 2026)**

immerse yourself in the celebrations — festive performances, irresistible shopping and dining, and exclusive gifts waiting to be redeemed. Come make this Chinese New Year truly unforgettable!

ARCHITECTURE

Exploring Chinese Architecture: A Harmonious Blend of Tradition and Innovation

Chinese architecture is a captivating art form that has evolved over millennia, merging cultural heritage, philosophical ideals, and environmental responsiveness into architectural masterpieces. While deeply rooted in traditional principles, it continues to inspire contemporary architects.

Now we will explore the key elements of Chinese architecture and highlight the works of five innovative architecture firms—André Fu Studio, Vector Architects, OPEN Architecture, Neri&Hu Design and Research Office, and MAD Architects—who are shaping modern design while respecting Chinese architectural traditions.





André Fu Studio

André Fu Studio is renowned for its ability to blend Eastern and Western influences in interior design, creating serene and luxurious spaces. One of the most celebrated examples of this approach is The Upper House, a luxury hotel located in Hong Kong.

This hotel showcases Fu's minimalist philosophy, where simplicity meets elegance. Drawing from Chinese architectural principles, the design emphasizes tranquility and the natural flow of space. The interiors use neutral colors and natural materials, such as stone and wood, to create a peaceful retreat in the heart of a bustling city. The hotel's open spaces, lush greenery, and calming color palettes embody the Chinese principle of balance, offering a harmonious experience for guests. The Upper House stands as a prime example of how contemporary Chinese architecture can incorporate traditional aesthetics within a modern luxury context.







Vector Architects

Vector Architects is celebrated for their meticulous attention to context and use of natural materials. Their project, Chapel of Music in Ningbo, China, reflects their skill in creating serene, contemplative spaces that respect both architectural tradition and modern simplicity.

The Chapel of Music is a small, minimalist structure designed to serve as a sacred, meditative space for visitors. The chapel's use of raw concrete and natural stone, along with large windows framing the surrounding landscape, creates a sense of openness and connection to nature. This design draws on the ancient Chinese reverence for nature, integrating it into the building's very fabric. The chapel's simplicity and quiet elegance offer visitors a peaceful environment, highlighting Vector Architects' ability to combine Chinese architectural ideals with modern materials and design.

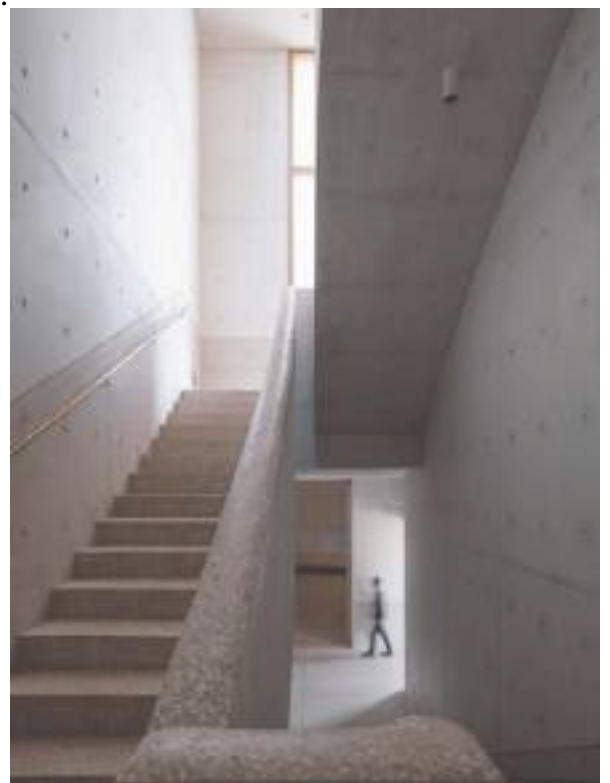



Vector Architects



OPEN Architecture is a firm known for its forward-thinking designs that blend digital technology with architectural tradition. One of their most groundbreaking projects is SPACE CRYSTALS – A Digital Space Museum and Experience Center, located in Beijing, China.

This project represents a fusion of traditional Chinese architecture and cutting-edge digital technologies. The SPACE CRYSTALS experience center integrates augmented reality (AR) and virtual reality (VR) to immerse visitors in a futuristic exploration of space. The interior is designed using abstract, geometric forms, with crystal-like structures that serve both an aesthetic and functional purpose. These elements pay homage to Chinese architectural traditions by blending fluid shapes and modernity, creating an environment that is both visually captivating and highly interactive. This project pushes the boundaries of architectural and interior design by using technology to create a space where digital and physical environments coexist harmoniously.

OPEN ARCHITECTURE





Neri&Hu



Neri&Hu Design and Research Office

Neri&Hu Design and Research Office was founded by Lyndon Neri and Rossana Hu, and they are known for seamlessly blending modern design with historical and cultural references. A key project that showcases their expertise is The Waterhouse at South Bund in Shanghai, a boutique hotel housed in a former industrial warehouse.

The design of The Waterhouse is a fusion of industrial elements and traditional Chinese design values. The hotel retains the rawness of its former life with exposed concrete and steel, while incorporating warm materials like wood and bamboo to soften the space. The use of traditional Chinese screens and lanterns creates a balance between modern minimalism and cultural heritage.







MAD Architects

MAD Architects, led by Ma Yansong, is known for its futuristic, organic designs that challenge conventional architectural boundaries. One of their most iconic projects is Chaoyang Park Plaza in Beijing, a striking example of how contemporary architecture can merge with Chinese architectural elements.

The design of Chaoyang Park Plaza features fluid, curvaceous forms that stand in contrast to the rigid grid of the surrounding city. The interior spaces reflect the same organic, flowing design principles, creating a sense of openness and connection to nature. The use of glass, stone, and wood allows the interior to embrace the natural world while maintaining a futuristic feel. This integration of nature and modernity aligns with traditional Chinese architectural principles that emphasize the harmony between man-made structures and the environment. Chaoyang Park Plaza demonstrates MAD Architects' ability to blend futuristic aesthetics with the cultural and natural influences that define Chinese architecture.





INSIGNIA INTERIOR

Interior Design
Architectural Design
Design & Build
Fit Out Specialist
Project Management

WEBSITE

www.insigniainterior.com.my

FACEBOOK

Insignia Interior

INSTAGRAM

[insignia.interior](https://www.instagram.com/insignia.interior)

LINKEDIN

Insignia Interior Sdn Bhd

ADDRESS

75A, Jln Anggerik Emas 1,
Taman Anggeirk Emas
Skudai, 81300 Johor Bahru, Johor

CONTACT

016-733 0710

